

Questionnaire

Dear interested party,
in order to process your request as quickly as possible, we would like to ask you to fill out the following questionnaire.

1. Customer data

Company: Phone:
 Street: Mobile-no.:
 Postal code / Destination: E-Mail:
 Project manager: Contact to AGRICHEMA:

2. Inquiry about the following problem:

Discharge capacity: m³/h discharge continuously per charge

Operating hours of the equipment: h/a

3. Bulk material

Bulk material weight: t/m³ Humidity: %

Grain size: mm Fat content: %

Special particularities of the bulk material:

Food harmlessness: Yes No Bulk material temperature: °C

Bulk material sample: will be sent has been handed over not available

4. Bulk material characteristics

flows well	Yes <input type="checkbox"/>	No <input type="checkbox"/>	flushes out	Yes <input type="checkbox"/>	No <input type="checkbox"/>	sticks together	Yes <input type="checkbox"/>	No <input type="checkbox"/>
hygroscopic	<input type="checkbox"/>	<input type="checkbox"/>	subject heavy wear	<input type="checkbox"/>	<input type="checkbox"/>			

5. Explosion protection

Version not suitable for underground and gas zones!

explosive Yes ¹⁾ No

¹⁾ if case, please specify: Dust zone inside: Dust zone outside:

Minimum ignition energy of the bulk material: mJ

Minimum ignition temperature of the bulk material: °C

6. Operating conditions

Location:	<input type="text"/>	Operating pressure:	<input type="text"/>
Ambient temperature:	<input type="text"/>	Type of protection:	<input type="text"/>
Operating voltage:	<input type="text"/>	Control voltage:	<input type="text"/>

7. Further boundary conditions

Method of filling:	<input type="text"/>
Pressure at site:	<input type="text"/>
Method of discharge:	<input type="text"/>
Silo material:	<input type="text"/>
Material specifications for components to be delivered:	<input type="text"/>

8. Remarks (i.e. data for silo geometry)

Supplemental Questionnaire MODUFLEX-Louder

Sheet 1 of 2

Please mark desired version

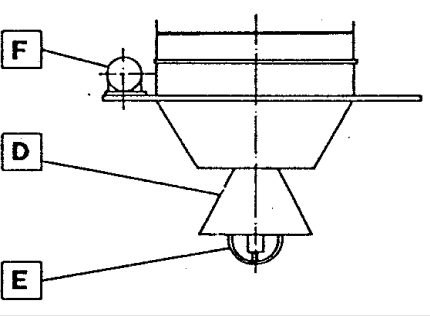
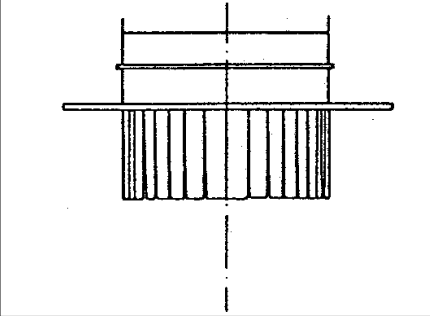
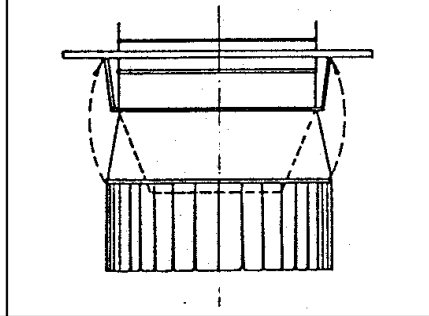
<input type="checkbox"/> Enclosed loading	<input type="checkbox"/> Open loading	<input type="checkbox"/> Combined loading
<input type="checkbox"/> Silo vehicles <input type="checkbox"/> Railway wagons <input type="checkbox"/> <input style="width:100%; height:15px;" type="text"/>	<input type="checkbox"/> Flatbed vehicles <input type="checkbox"/> Ships <input type="checkbox"/> <input style="width:100%; height:15px;" type="text"/>	<input type="checkbox"/> 1 <input type="checkbox"/> 4 <input type="checkbox"/> 2 <input type="checkbox"/> 5 <input type="checkbox"/> 3 <input type="checkbox"/> 6
		
Outlet head with top-mount cone	Outlet head with dust skirt and support basket	Outlet head with top-mount cone and dust skirt (to fold up)
(D) Locking cone Yes No <input type="checkbox"/> <input type="checkbox"/>	Rubber coating on outlet cone Yes No <input type="checkbox"/> <input type="checkbox"/>	<input type="checkbox"/> Dust skirt (can be folded up manually) <input type="checkbox"/> Dust skirt (electrical)
(E) Filling indicator Construction: <input type="checkbox"/> Pneumatic <input type="checkbox"/> Capacitive <input type="checkbox"/> Revolving wing <input type="checkbox"/> Tuning fork	Yes No <input type="checkbox"/> <input type="checkbox"/>	<input type="checkbox"/> 230 V, 50 Hz <input type="checkbox"/> 24 V <input type="checkbox"/> <input style="width:100%; height:15px;" type="text"/>
(F) External vibrator	Yes No <input type="checkbox"/> <input type="checkbox"/>	<input type="checkbox"/> 230 / 400 V, 50 Hz <input type="checkbox"/> <input style="width:100%; height:15px;" type="text"/>
MODUFLEX-Louder with filter?	Yes No <input type="checkbox"/> <input type="checkbox"/>	if, yes Integrated filter <input type="checkbox"/> Side cartridge filter <input type="checkbox"/>
Control bulb	Yes No <input type="checkbox"/> <input type="checkbox"/>	
Electronic control	Yes No <input type="checkbox"/> <input type="checkbox"/>	
Other items: Parts in contact with bulk materials: <input type="checkbox"/> Nylon-cones <input type="checkbox"/> St <input type="checkbox"/> Cr - Ni - St <input style="width:100%; height:15px;" type="text"/> <input style="width:100%; height:15px;" type="text"/>		

Supplemental Questionnaire MODUFLEX-Louder

Sheet 2 of 2

Diagrams and remarks

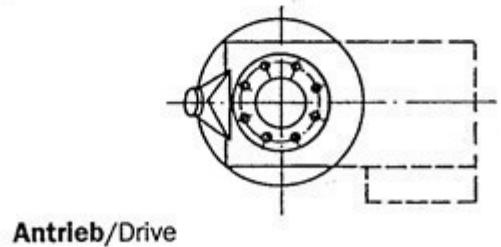
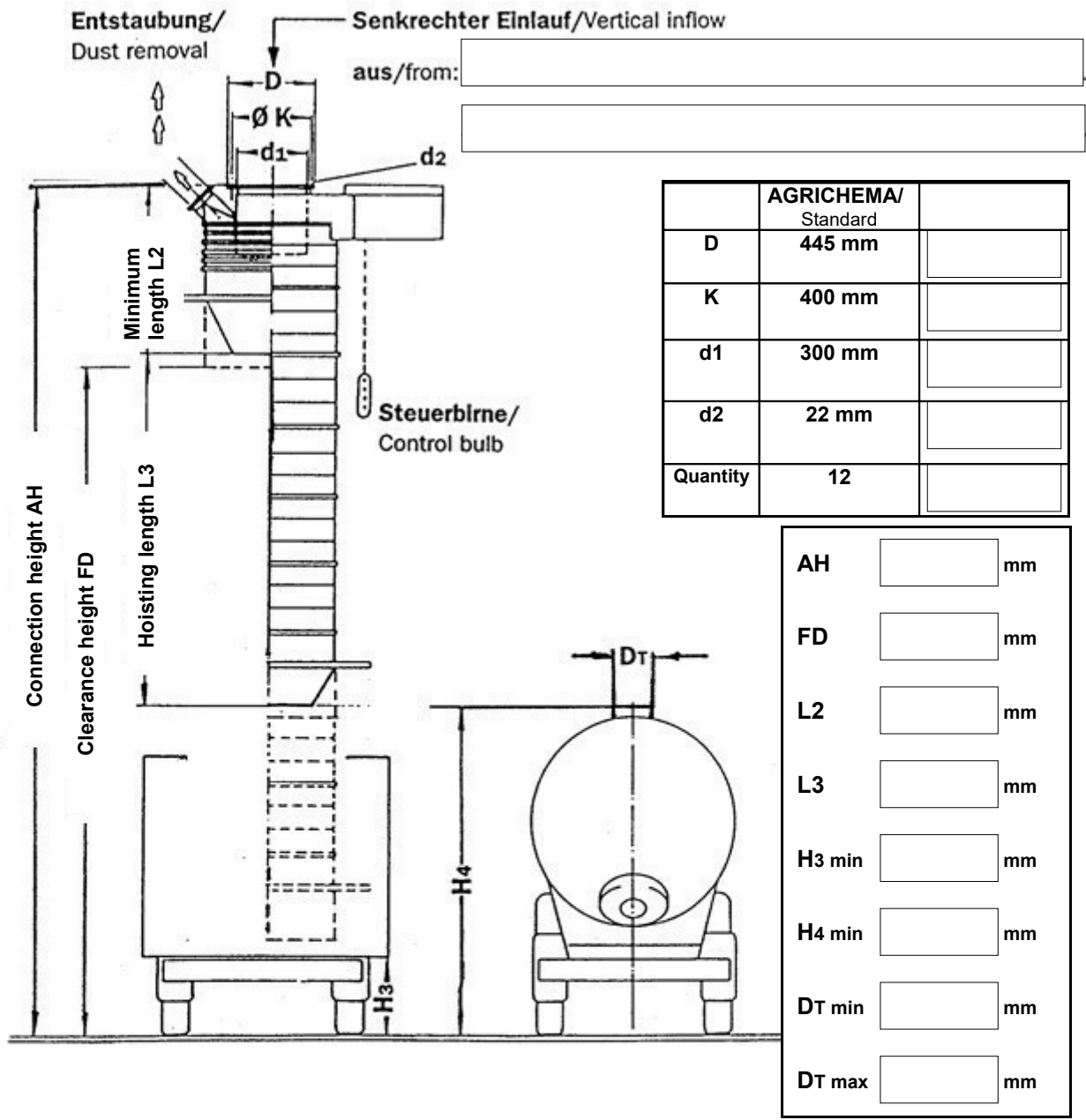

Getriebemotor mit Selltrommel/
Back-gear motor with rope barrel

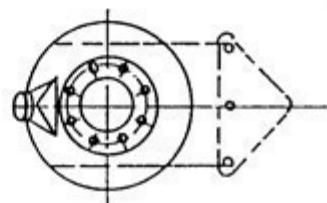

Handwinde mit Selljoch/
Hand winch with rope hitch